

# Connect to CUGuest with Windows PC / Notebook

*(This user guide is applicable to Win 7 or above)*

## Service Description

- A. [Detect a WiFi Signal of CUGuest](#)
- B. [Connect to CUGuest](#)

### A. Detect a WiFi Signal of CUGuest

a. Turn on the Wi-Fi function on the computer (please refer to computer user manual for more details)

Click the Wi-Fi icon on the system tray.

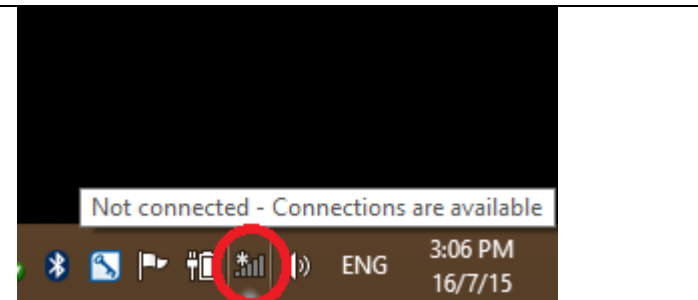

b. Available wireless networks will be listed.

Select **CUguest**, and then click **Connect**.

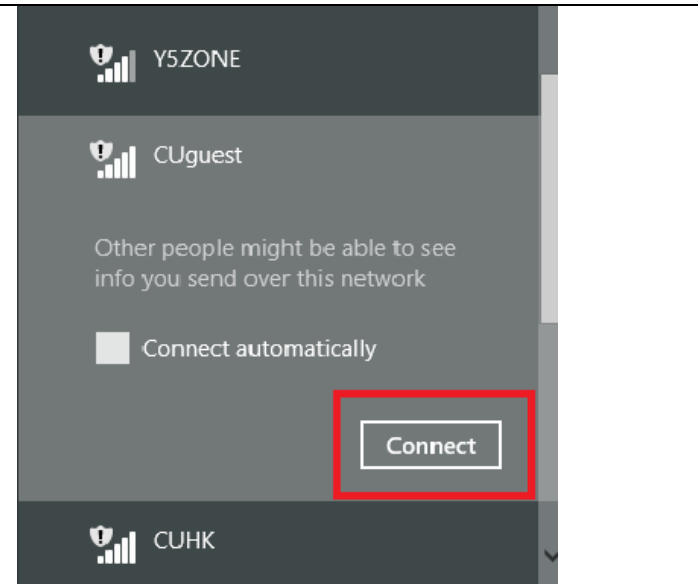

c. While connecting, be patient to wait for successful connection.

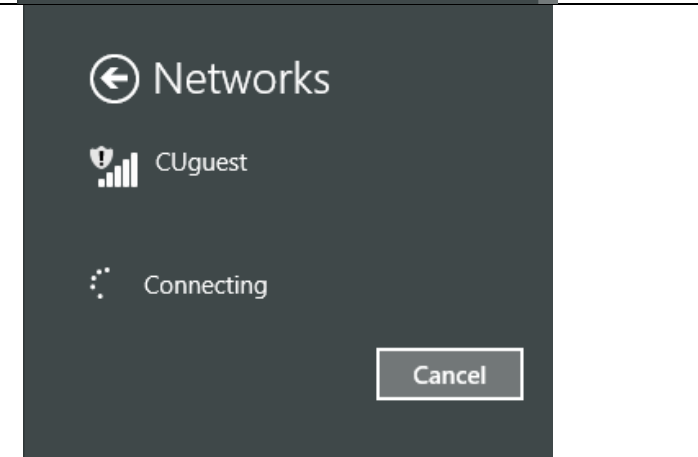

## B. Connect to CUguest

a. Open a browser and visit any homepage e.g. The HKSAR page at <http://www.gov.hk> .

Note:

1. User can browse CUHK homepage at <http://www.cuhk.edu.hk> even without logging-in the Wi-Fi service
2. User may encounter a certificate warning message if no CUHK Root Certificate has been installed in the browser. For details and the installation guide of the certificate, please visit <http://www.cuhk.edu.hk/ca/browser-err.html>.

b. Browser will prompt to **Use Policies and Guidelines of CUguest Wi-Fi Service** page. Click **Accept** to continue.

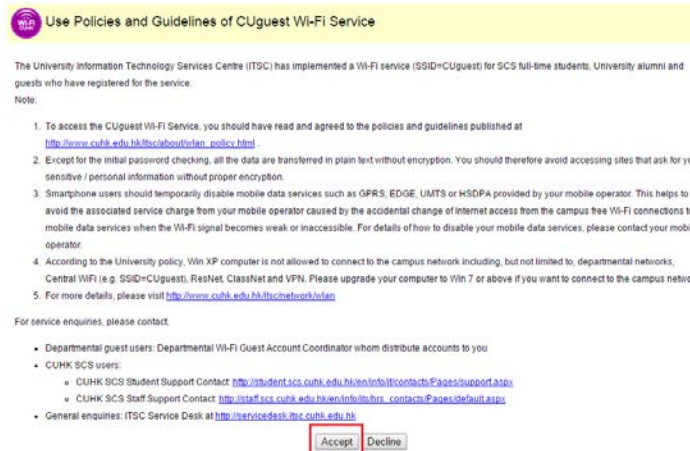

**Use Policies and Guidelines of CUguest Wi-Fi Service**

The University Information Technology Services Centre (ITSC) has implemented a Wi-Fi service (SSID=CUguest) for SCS full-time students, University alumni and guests who have registered for the service.

Note:

1. To access the CUguest Wi-Fi Service, you should have read and agreed to the policies and guidelines published at [http://www.cuhk.edu.hk/itc/about/faq\\_scs/cu.html](http://www.cuhk.edu.hk/itc/about/faq_scs/cu.html)
2. Except for the initial password checking, all the data are transferred in plain text without encryption. You should therefore avoid accessing sites that ask for your sensitive / personal information without proper encryption.
3. Smartphone users should temporarily disable mobile data services such as GPRS, EDGE, UMTS or HSDPA provided by your mobile operator. This helps to avoid the associated service charge from your mobile operator caused by the accidental change of internet access from the campus free Wi-Fi connections to mobile data services when the Wi-Fi signal becomes weak or inaccessible. For details of how to disable your mobile data services, please contact your mobile operator.
4. According to the University policy, Win XP computer is not allowed to connect to the campus network including, but not limited to, departmental networks, Central WiFi (e.g. SSID=CUguest), ResNet, ClassNet and VPN. Please upgrade your computer to Win 7 or above if you want to connect to the campus network.
5. For more details, please visit <http://www.cuhk.edu.hk/itc/network/faq>

For service enquiries, please contact:

- Departmental guest users: Departmental Wi-Fi Guest Account Coordinator whom distribute accounts to you
- CUHK SCS users:
  - CUHK SCS Student Support Contact <http://itbident.scs.cuhk.edu.hk/en/info/contacts/Pages/support.aspx>
  - CUHK SCS Staff Support Contact [http://itstaff.scs.cuhk.edu.hk/en/info/itc/hr\\_contacts/Pages/default.aspx](http://itstaff.scs.cuhk.edu.hk/en/info/itc/hr_contacts/Pages/default.aspx)
- General enquiries: ITSC Service Desk at <http://service-desk.itc.cuhk.edu.hk>

c. At **Login to CUGuest Wi-Fi Service** page, enter the following:

**User ID**

1. **CUHK Alumni:**  
Alumni ID + @alumni.wifi  
(i.e. 1xxxxxxx@alumni.wifi)
2. **CUHK SCS Students:**  
SCS ID+ scs.cuhk.edu.hk  
(i.e.3xxxxxx@scs.cuhk.edu.hk)
3. **Visiting guests**  
(i.e.gxxxxx@guest.cuhk.edu.hk)
4. **Conference**  
(i.e.Confx@conference.cuhk.edu.hk)

**Password**

the corresponding password  
Then click **Log In**.

d. A window showing **Login successful** will pop up.

User may enjoy CUGuest Wi-Fi service from now on.

The screenshot shows two parts of the login process. The top part is the 'Login to CUGuest Wi-Fi Service' page, which includes a 'Note' section with five points, a list of user categories, and a login form with fields for 'User ID', 'Password', and a dropdown for 'Please select your user category'. A red box highlights the 'Log In' button. The bottom part is a success message: 'You have been successfully login to CUGuest Wi-Fi Service', with a 'Logout' button and a 5-second redirect timer.

**Login to CUGuest Wi-Fi Service**

Note:

1. The CUGuest Wi-Fi Service is for CUHK alumni, SCS full time HD and top-up degree students, visiting guests, and conference participants registered for the service only.
2. Logging in the service indicates you have read and accepted the [User Policies and Guidelines](#).
3. Except for the initial password checking, all the data are transferred in plain text without encryption, therefore, please do not carry out sensitive activities with this connection.
4. The Wi-Fi connection will be disconnected if the connection has been idle for an hour; should that happen, please login again for reconnecting to the service.
5. According to the University policy, Win XP computer is not allowed to connect to the campus network. Please upgrade your computer to Win 7 or above if you want to connect to the campus network.

Please enter your User ID and Password to login CUGuest Wi-Fi Service. Your User ID is

- CUHK Alumni: your 10-digit Alumni ID (e.g. 1234567891)
- CUHK SCS Students: your 8-digit ID (e.g. 31234567)
- Visiting Guests: your Account ID (e.g. g123456)
- Conference Participants: your User ID (e.g. Conf1)

User ID   -- Please select your user category --

Password

For service enquiries, please contact.

- CUHK Alumni: Visit Alumni Affairs Office homepage for [Alumni ID](#) and [service details](#)
- CUHK SCS users:
  - CUHK SCS Student Support Contact <http://student.scs.cuhk.edu.hk/en/info/contacts/Pages/support.aspx>
  - CUHK SCS Staff Support Contact [http://staff.scs.cuhk.edu.hk/en/info/itshrs\\_contacts/Pages/default.aspx](http://staff.scs.cuhk.edu.hk/en/info/itshrs_contacts/Pages/default.aspx)
- Visiting Guests: Departmental Wi-Fi Guest Account Coordinator whom distribute accounts to you
- Conference Participants: Conference Organiser whom distribute accounts to you
- General enquiries: ITSC Service Desk at <http://services@it-sc.cuhk.edu.hk>

Information Technology Services Centre, The Chinese University of Hong Kong

---

**You have been successfully login to CUGuest Wi-Fi Service**

In 5 seconds, you will be automatically redirected to your original visiting page.

Information Technology Services Centre, The Chinese University of Hong Kong.

Tips: Please note the followings if you cannot see the prompt window at step 3a.

- You need to allow “Enable pop-ups” in Google Chrome:

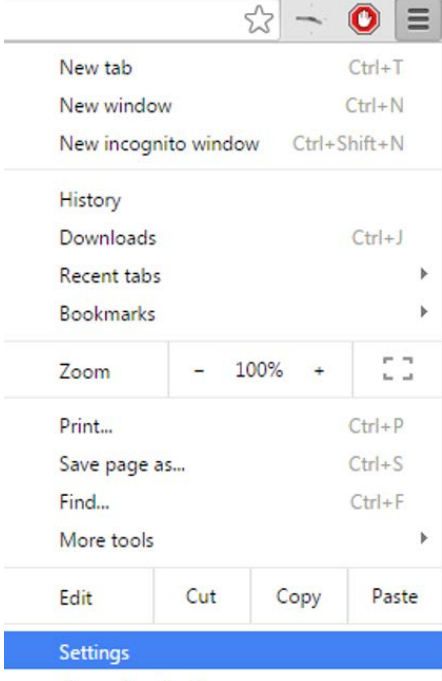
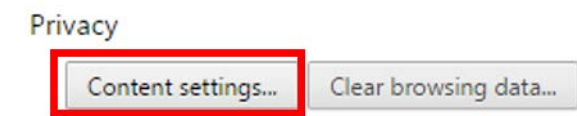
|  |   |
|--|---|
| a. Click <b>Settings &gt; Show advance settings</b> (at the bottom). |  <p>The screenshot shows the Google Chrome menu with the following items: New tab (Ctrl+T), New window (Ctrl+N), New incognito window (Ctrl+Shift+N), History, Downloads (Ctrl+J), Recent tabs, Bookmarks, Zoom (100%), Print... (Ctrl+P), Save page as... (Ctrl+S), Find... (Ctrl+F), More tools, Edit, Cut, Copy, Paste, and Settings (highlighted in blue).</p> |
| b. Under Privacy, click <b>Content settings</b> .                    |  <p>The screenshot shows the Privacy settings section with the following items: Content settings... (highlighted with a red box) and Clear browsing data...</p>   |

- c. Under Pop-ups, by default Do not allow any site to show pop-ups (recommended)  
Click on Manage exceptions..

Type hostname pattern: [\*].cuhk.edu.hk

Add Allow

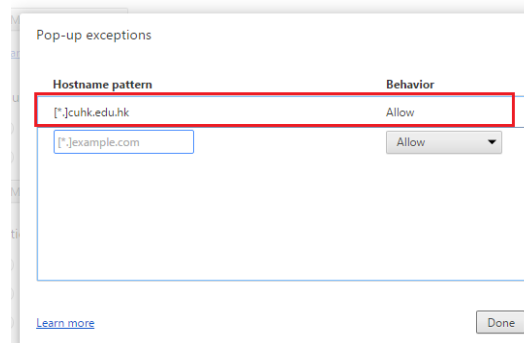
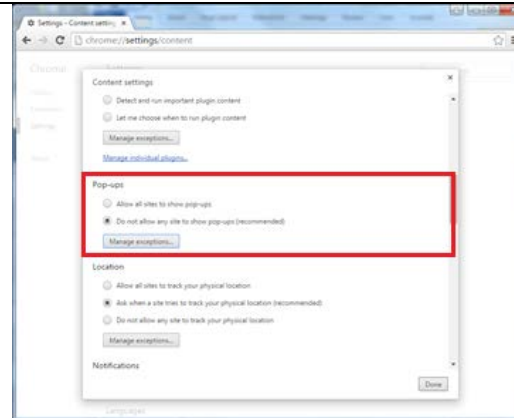

- You need to allow "Enable pop-ups" in Firefox:

a. Click **Options**  
(or **Preferences** for  
other versions).

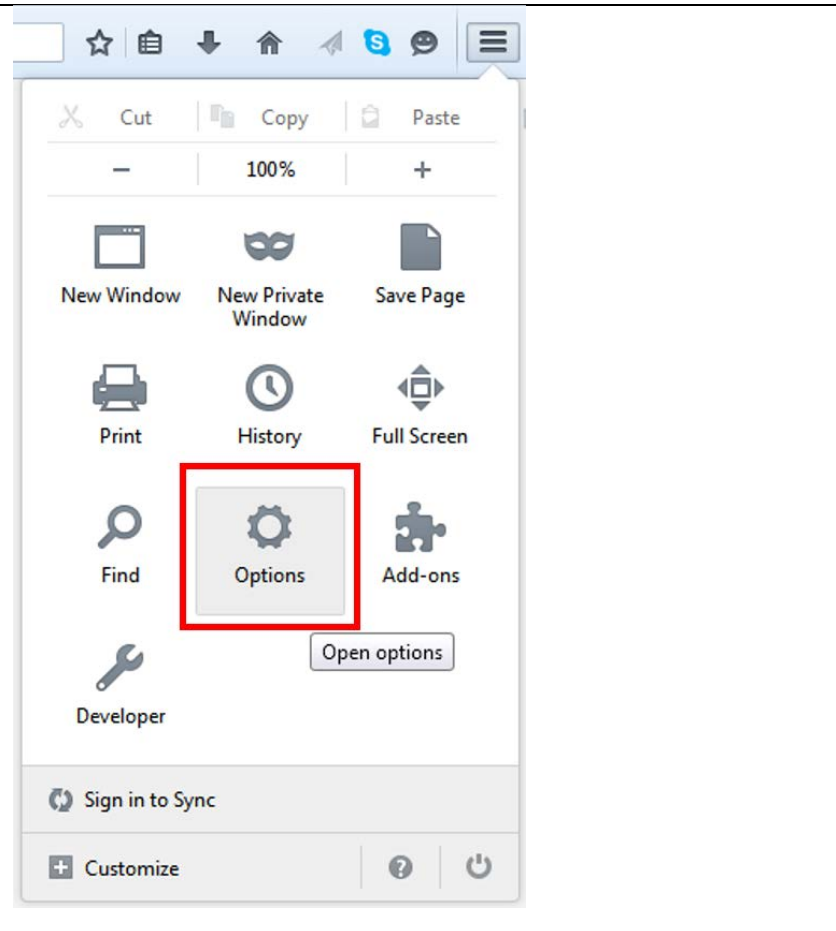

b. Under **Content**, by default, **Block pop-up windows** is enabled.

Add Exception

Type Address of website: \*.cuhk.edu.hk

Click "Allow"

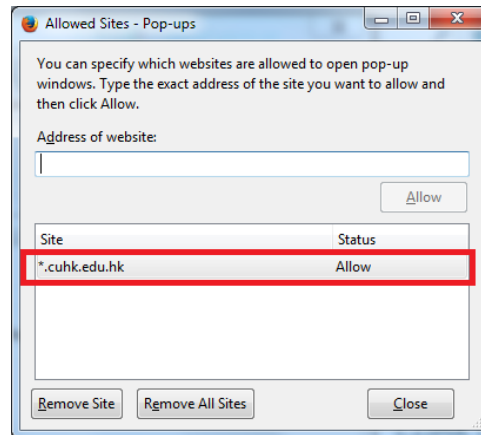
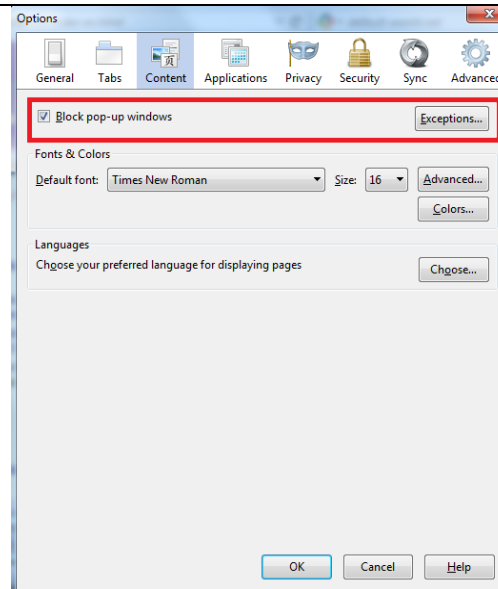

Last Update: 29 June 2016

Copyright © 2016. All Rights Reserved. Information Technology Services Centre, The Chinese University of Hong Kong